



Global Vision, Local Execution.

The Atlas Copco Cagayan de Oro Branch Office —
A Completed Project by JMG Construction.

ZONE 7 VLV BUILDING, BULUA HIGHWAY



The Client

Atlas Copco Philippines (Swedish origin, world-leading sustainable productivity solutions).



The Contractor

JMG Construction & General Merchandise (Led by Engr. Jasper M. Gementiza).

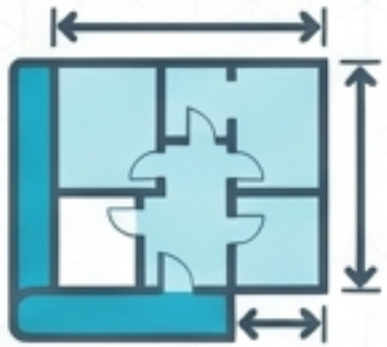

The Scope

178.32 sqm comprehensive design and modern office fit-out in Canitoan, Cagayan de Oro.



The Result

Delivered a globally compliant workspace in a strict 12-week timeframe.

Global Standards

(Atlas Copco Facility Branding Manual 2021)



Mandates the exact use of PMS 313 Blue and White



Scandinavian minimalism and transparent acoustic zones



Heavy emphasis on natural light and sustainability

Local Execution

(The JMG Mandate)



Execute uncompromising European standards within a local footprint in Mindanao



Utilize value engineering to balance premium aesthetics with a localized budget

Core Objective: Create a space that instantly communicates the brand's 'First in Mind – First in Choice' ethos.

Spatial Strategy & Zoning

Total Footprint: 178.32 sqm

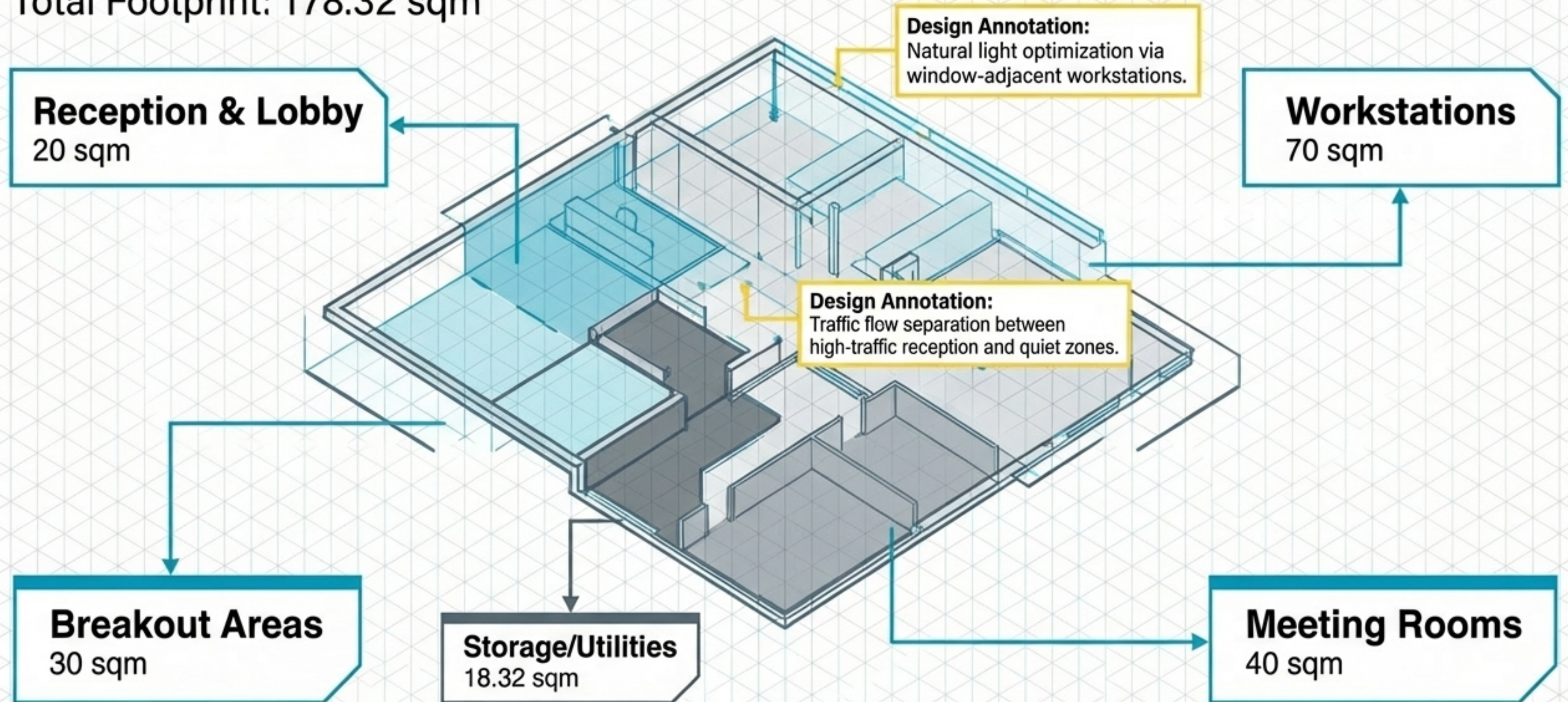

Value Engineering & Scope



Original Estimate
PHP 3.52M

JMG Best Offer
(PO #8000085466)
PHP 3.20M

Savings Generated
~PHP 329,000
without compromising structural integrity or brand aesthetics.

Architectural Mastery

Glass Partitions

Full-height transparent walls ensuring acoustic privacy while maintaining light flow and an open-culture aesthetic.

Precision Flooring

89 sqm of high-grade epoxy flooring applied with meticulous floor preparation to ensure a seamless, industrial-chic finish.

Drywall Execution

Perfectly aligned Scandinavian minimalist partitions serving as the canvas for the brand colors.



MEP & Sustainability Integration

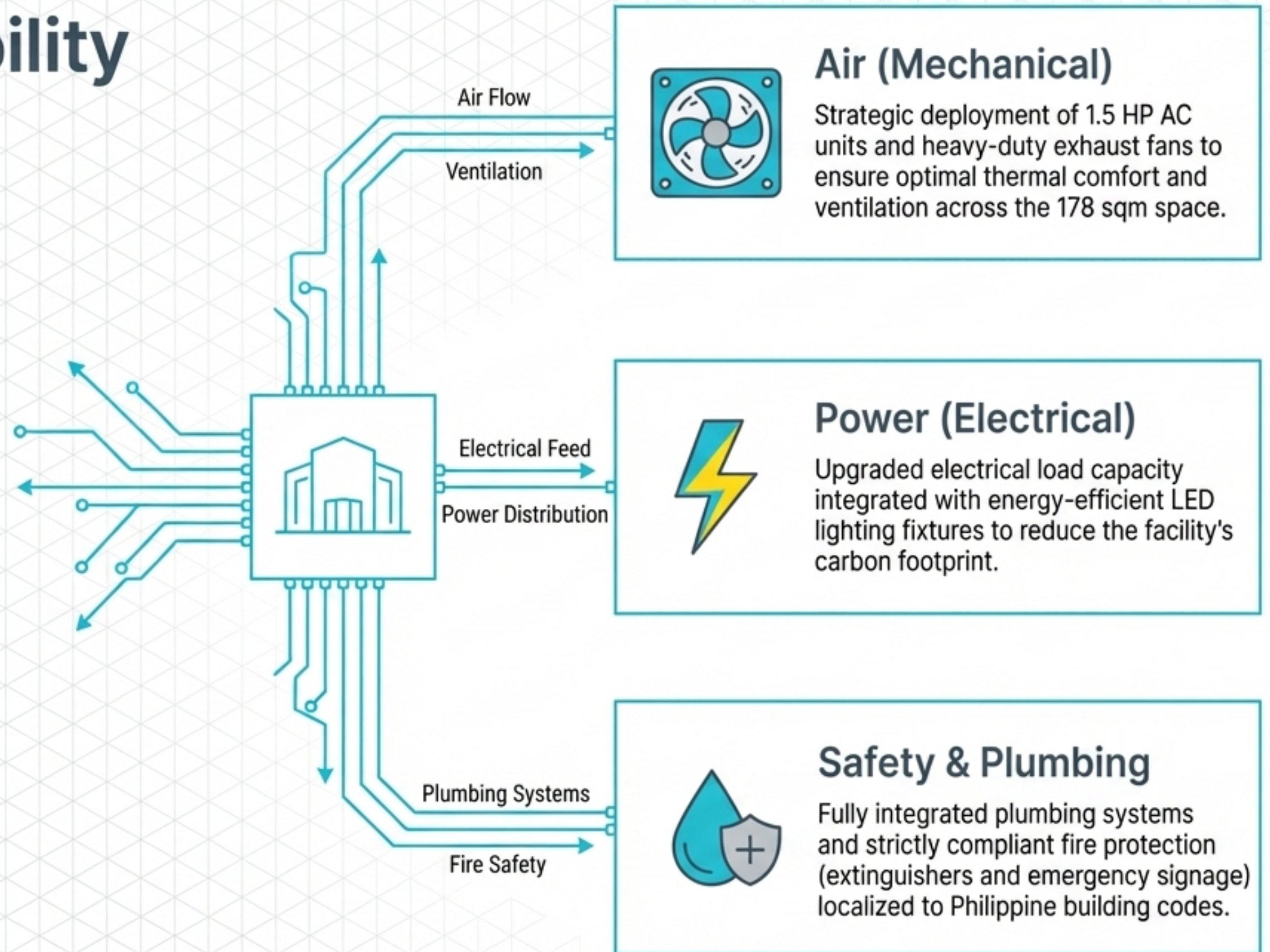

Render vs. Reality

Label 1: The Digital Blueprint

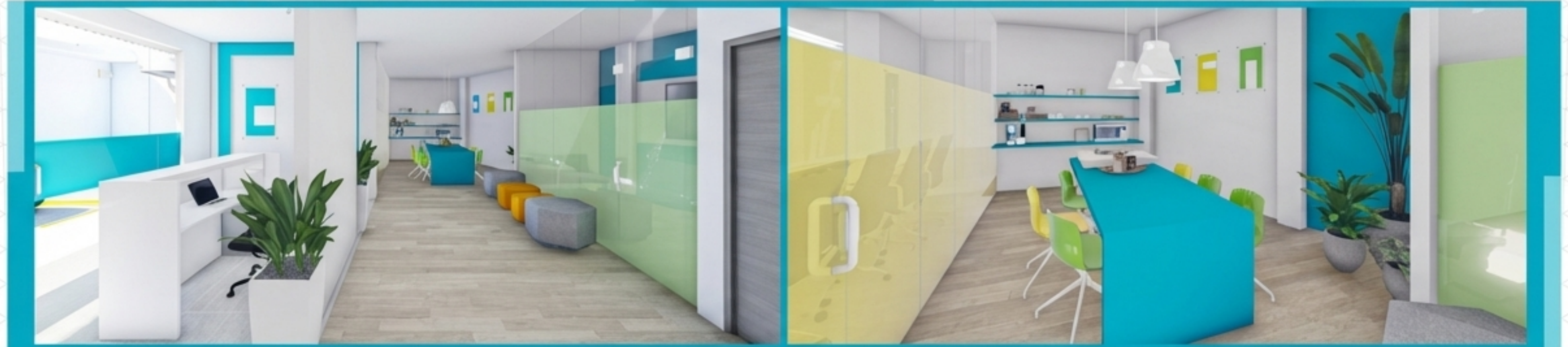

Label 2: The JMG Execution

Key Insight: What is drawn is exactly what is built. Zero aesthetic compromises.

The Finished Space: The Reception

The Brand Gateway

Precision application of the PMS 313 Blue corporate banding across the frameless glass entrance.

First in Mind

Creating an immediate sense of global professionalism and Scandinavian cleanliness the moment employees and clients cross the threshold.

Atlas Copco
(Philippines) Inc.

The Finished Space: The Boardroom & Workstations

Collaborative Design

U-shaped meeting configurations promoting equal interaction.

Ergonomics

Integration of highly adjustable, lumbar-supporting **ergonomic** seating.

Environment

Stark white walls maximizing light reflection, paired with highly responsive **AC units** for sustained comfort during long operational hours.



Timeline & Agility

📍 March 12, 2025

Core Timeline: 12 Weeks from Site Prep to Turnover

Operational Agility

Seamlessly integrated massive mid-project additions without derailing the core turnover date.

Agility Track

Electrical Expansion

PHP 120k

Linear lighting, THHN rewiring

Workshop Expansion

PHP 324k

3HP AC units, steel fire exits

Civil Expansion

PHP 176k

Canopy extensions

Project Acceptance & Turnover

100%

completion achieved
at final turnover.

Compliance Check

100% clearing of demolition, architectural drywall, glass systems, epoxy, and MEP provisions.

Safety & Cleanliness

Total site demobilization and debris clearing aligned with Atlas Copco's environmental regulations.

Project Acceptance

Formal sign-off and turnover between Engr. Jasper M. Gementiza (JMG) and Atlas Copco Representatives.

Translating global standards into local realities requires more than just materials; it requires a strategic partnership built on precision and trust.

**The JMG Philosophy:
“We Design, Build,
and Value People.”**

**JMG Construction delivers uncompromising quality, ensuring that anywhere in the world a brand operates, its physical space remains world-class.
Atlas Copco is the completed project by JMG Construction.**

JMG CONSTRUCTION

ATLAS COPCO